

Solutions Guide: Signage Plus

Modernize corporate digital signage with a content delivery system to distribute any media to any display.

Digital signage in the enterprise is traditionally managed in silos using a variety of proprietary hardware solutions or even DIY tools. These solutions lack the standard infrastructure requirements needed for IT teams to efficiently and securely scale and support corporate communications.

IT teams need a reliable, future-proof solution with central management that also allows stakeholders across the organization to create and present content wherever and whenever needed.

Userful™ provides enterprise-class infrastructure management capabilities and intuitive content creation tools for an end-to-end solution that supports the IT infrastructure while allowing functional departments the ability to create and present any video or signage content onto any screen, video wall, or LED wall worldwide.

Infinity Applications for Corporate Signage



Engage enables the distribution of any media to any display.



Artistic enables unique and very large video walls with video content of almost any resolution.



Spaces delivers advanced screencasting for meeting rooms and flex spaces.



Remote enables local and remote users to access relevant visual content.

Corporate Signage Use Cases

Userful's software-defined enterprise AV-over-IP modernizes digital signage deployments of all kinds.



Corporate Communications



Operational Signage

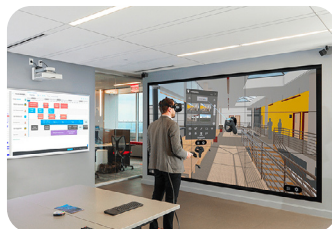

Collaboration Environments



Lobbies & Experience Centers

Userful Infinity Platform Architecture Diagram

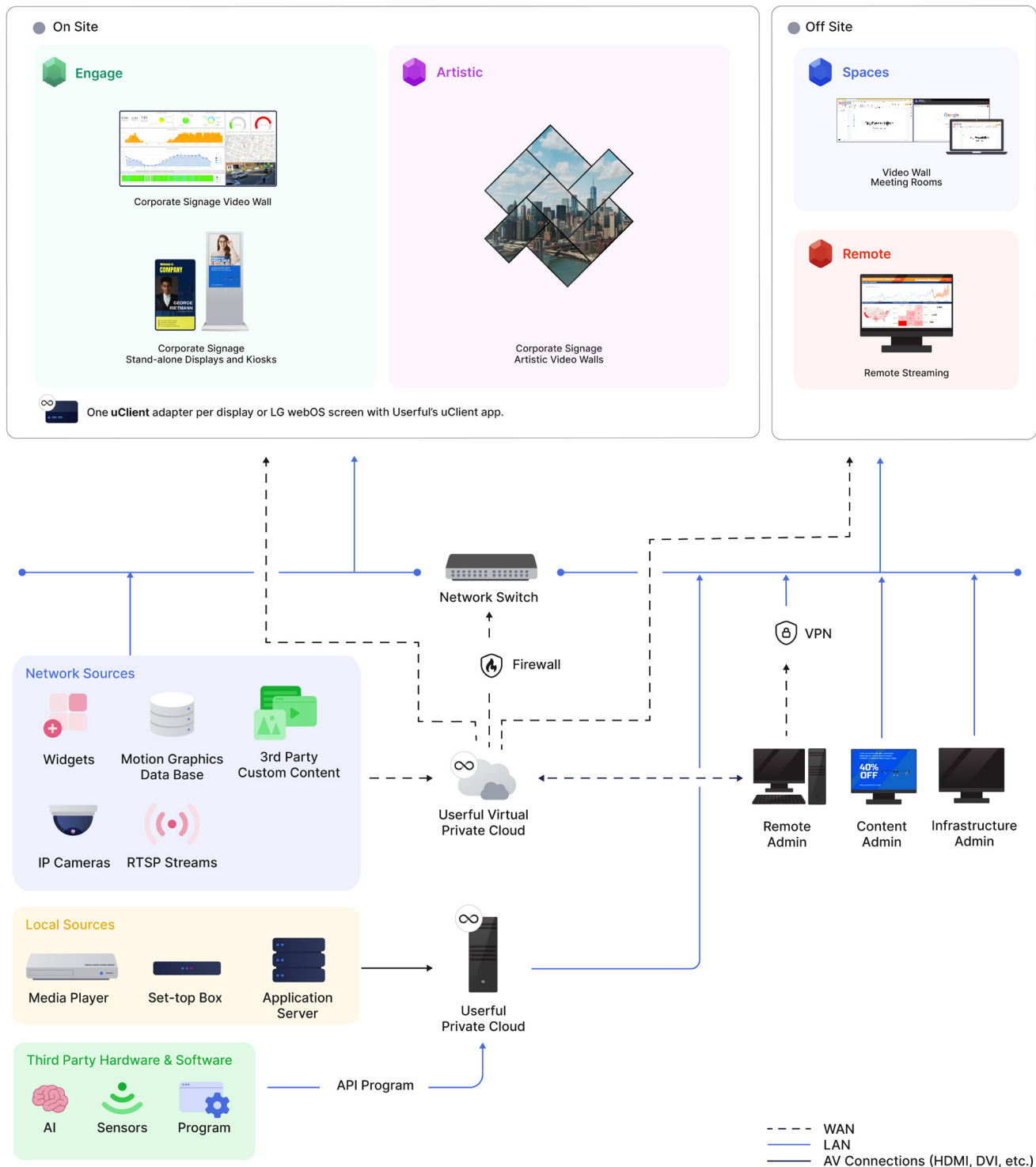







Three-year software subscription that includes support for a Userful certified server with up to one (1) active GPU and up to 32 CPU cores in use. Includes access to all Userful platform functions and applications, but is primarily for use with Userful's Signage applications due to limited server resources. Includes unlimited Artistic static signage player licenses, 10 Engage licenses with access to cloud-based CMS, standard support, and allows for additional failover server.

Solution Components

Component	Description
Userful Infinity Platform License	Enterprise AV-over-IP software application suite built on modular, micro services architecture with 1-N server support, multi-GPU support, virtualization support, and an entire suite of integrated gemstone applications. To learn more view data sheet .
Engage Application	A content delivery system to easily create signage from over 400 templates. Includes widgets and applications such as clocks, weather, RSS feeds, and more. Supports split screen to create areas for multiple content sources. To learn more view data sheet .
Artistic Application	One of a kind artistic video walls and immersive video experiences for corporate lobbies and public spaces. Ad Hoc rotation and placement of displays. Play video content up to 8k60fps in real time, supports splitting for even larger content. Supports playlisting, scheduling and text overlay. To learn more view data sheet .
Spaces Application	Secure content sharing for meeting rooms and collaboration spaces. Deployed on a private cloud server, operates on any display, WebRTC-based, multi-participant screen sharing with wireless screencast support. To learn more view data sheet .
Remote Application	Stream content, townhalls and other videos to remote employees. Deployed on a private cloud server, it streams any source on the network, including videos and multiple sources. Compatible with any web browser. To learn more view data sheet .
On-Premise Private Cloud Server	Commercially available off-the-shelf and from leading brands such as Supermicro, Dell, Lenovo, and HP. Compatible with Intel, Xeon and AMD threadripper Processors and Nvidia Quadro / RTX A series cards. To learn more view data sheet .
Public Cloud Server	Public cloud hosted service for Userful Engage application including content creation, hosting, management and global delivery. Customers can also host their Userful server on a public cloud for use with signage applications including Emerald and Amethyst.
Switch	L2 and L3 compatible switches; Cisco, Netgear, Ubiquity, HP.
Userful uClient Adapter	L2 and L3 device, up to 4K resolution, Android 7, wifi compatibility, 10/100/1000 LAN, SD compatible, 4Gb RAM, 32 GB Local Storage, RK3399 processor, HDMI output, 3.5mm audio jack. Manageable via Userful platform including power management, storage, remote updates, remote reboots and more. To learn more view data sheet .
Userful uClient App	Soft client application for Userful Infinity Platform. Compatible with Android and LG webOS. To learn more view data sheet .
Zero Client	L2 device, listens to server broadcast, no operating system or moving parts, 10/100/1000 LAN, up to 1080p, HDMI and VGA output, 3.5mm audio jack.
dvLED Video Wall	The Userful LED Media Commander allows seamless connection of DV LED walls with multiple controllers. Up to 16K canvas with MultiGPU. To learn more view data sheet .
LG WebOS video wall or screens	The Userful uClient App is directly installed on supported LG WebOS displays. No additional hardware needed.
Other Video Walls or Screens	For all other displays, add a Userful uClient adapter to each display.
Content Sources	Ultra high resolution content, images, videos, social media, RSS feeds, custom created content from templates, live widgets, third party moving art, dashboards, emergency notifications and more.
API	GraphQL API to programmatically control and update content from third party applications, sensors and hardware devices.
Service and Support	24/7 online support, patches, and updates included in subscription.

Infinity Platform Benefits

All of the applications in this Solutions Guide are part of the Useful Infinity Platform.

	Innovative Technology:	Platform separates management layer from application layer, delivering end-to-end control to IT, giving functional departments control of applications.
	Software-Defined:	Hyper-scalable software-defined architecture that supports additional use cases and expansion to new locations as well as interoperability with other applications.
	Comprehensive Security:	Can operate in a secure closed network environment (air-gapped mode). Complies with the OSI model and can adapt to any network. Integrates with customers' existing security protocols and supports SAML and LDAP for role-based access controls.
	Improved Operations:	Any content source delivered to any screen in any location with the flexibility to allow both local and central control.
	Supply Chain Friendly:	Uses only components with lead times typically 10 weeks or less to ensure deployment time frames can be met.
	Lowest Total Cost of Ownership:	Frees customers from the costly cycle of supporting and refreshing proprietary and specialized hardware.
	Energy Savings:	Reduces energy expenditure by eliminating unnecessary hardware.

About Useful

Userful™ is a leading provider of AV as a Service (AVaaS) for advanced operations of mission-critical environments and core workflows, serving IT organizations worldwide. Userful's unified software platform provides modernized services and management through a complete suite of enterprise AV applications for comprehensive organizational and situational awareness. Userful harnesses the same unified platform to provide global manageability through a single pane of glass.

The Useful Infinity Platform™ eliminates the need for proprietary hardware by using a single software-defined platform, enabling customers to stream any content source to any screen anywhere in the world in real time.

[Explore the Engage Data Sheet](#)

Consult with a Useful Expert

Consult with one of our subject matter experts to understand how we can simplify your AV infrastructure.

[Schedule Consultation](#)

